

EXPLOSION-PROOF ELECTRIC UNDERSLUNG CRANES EUMX/EUBX

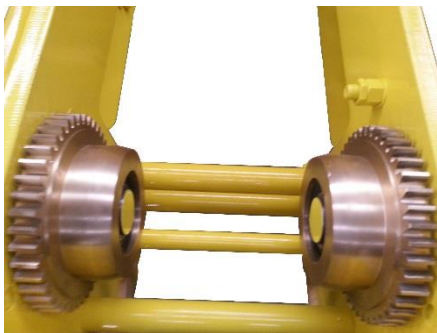

EUTX underslung (suspended) cranes are the best as versatility and features, matching requirements of hazardous areas. Our program includes single and double girders, we offer solutions with rolled steel sections, welded steel box and crane kits

EUMX single girder underslung travelling cranes

- capacity up to 12,5T

EUBX double girder underslung travelling cranes

- capacity up to 20T

High performance equipment

- high performance rope guide and chain guide according to hoist type
- load limiter
- up/down limit switch
- bronze wheels on trolleys
- high quality finish
- high performance motors
- anti-condensation heaters
- thermal probes
- first quality electric control components
- basic hazardous area Zone 2 IIB T3
- IP56 protection

On request

- rack and pinion transmission on horizontal movements
- stainless steel wire rope
- stainless steel hook block
- stainless steel bearing
- sliding assembly of trolley wheels for easy erection

| APPLICATION | CATEGORY | PROTECTION | EX PROTECTION CLASS |
|-------------|----------|------------|---------------------|
| Zone 1 | II 2 G | Gas | Exde IIB T4 |
| | | | Exde II C T4 |
| ZONE 2 | II 3 G | Gas | Exde II B T3 |
| ZONE 21 | II 2 D | Dust | ExtD A21 IP66 |

EXPLOSION-PROOF ELECTRIC UNDERSLUNG CRANES EUMX/EUBX

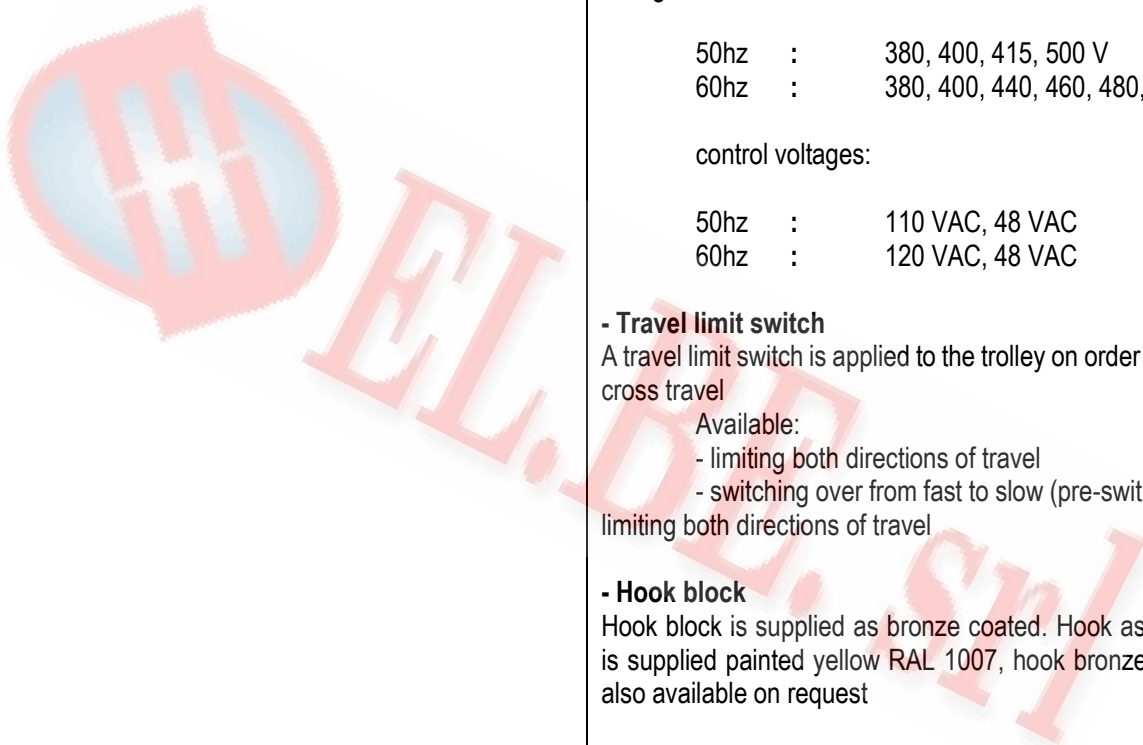
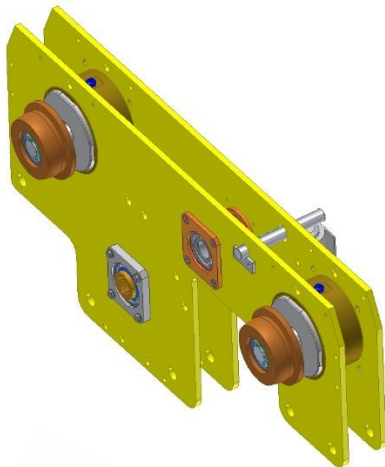

Explosion-proof electric connections

| | | | |
|--------|--------|------|------------------|
| ZONE22 | II 3 D | Dust | ExtD A22 IP66 |
|--------|--------|------|------------------|

- all trolleys are fitted with buffers
- electric trolleys are fitted with electric switch for travel limits

BCS type hoists are the best solution when two lifting speeds or long lifting heights are present. Two different motors (single polarity) are applied with a differential gear. No clutch or rotor slidings is present.

- standard controls are available for the following supply voltage:

| | | |
|------|---|--------------------------------|
| 50hz | : | 380, 400, 415, 500 V |
| 60hz | : | 380, 400, 440, 460, 480, 600 V |

control voltages:

| | | |
|------|---|-----------------|
| 50hz | : | 110 VAC, 48 VAC |
| 60hz | : | 120 VAC, 48 VAC |

- Travel limit switch

A travel limit switch is applied to the trolley on order to limit the cross travel

Available:

- limiting both directions of travel
- switching over from fast to slow (pre-switching) and limiting both directions of travel

- Hook block

Hook block is supplied as bronze coated. Hook as standard, is supplied painted yellow RAL 1007, hook bronze coated is also available on request

- Outdoor

For outdoor situation IP66 protection is applied
Heaters are applied to motors and control box

- Bronze wheels

Wheels are in solid alloyed bronze

- Painting/corrosion protection

Blasting of steel structure to degree SA2-protection of the whole hoist/trolley according to ambient and specification as required

- Towing arm for power supply

The towing arm for festoon system can be supplied. It is applied to the trolley

- Fall arrest brackets

EXPLOSION-PROOF ELECTRIC UNDERSLUNG CRANES EUMX/EUBX



In order to prevent falling in the case of breakage the trolleys are equipped with arrest brackets

- Buffers for trolleys

Buffers are fitted to all trolleys as standard

- Articulated trolleys

Articulated trolleys are used on curved runways. Two travel motors are recommended for narrow bends

- Main isolator

Max supply voltage 690 V

Explosion protection Exde IIB T4 max Exde IIC T6

Protection to IP65 EN 60529



GUB - IIC control panel

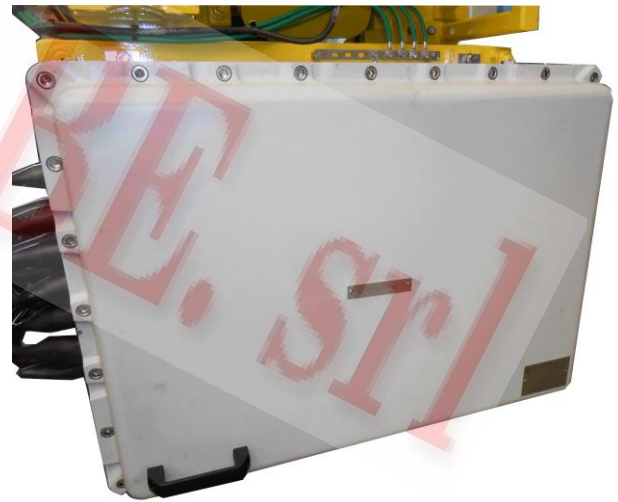

EJB IIB electric control panel

EXPLOSION-PROOF ELECTRIC UNDERSLUNG CRANES EUMX/EUBX



Stainless steel hook block



Push buttons station XAW-P

EL.BE.Srl